



SERIES 1 ATTACHMENTS

60 INCH POUNDS
#6 PIN MAX WITH ALUMINUM COLLARS

THE NEW STYLE SERIES 1 L ATTACHMENTS ARE MADE FROM THE LONGEST WEARING, STRONGEST MATERIALS AVAILABLE.

THE NEW BALL BEARING GEAR DESIGN HAS A VERY LOW AMOUNT OF FRICTION FOR ACCURATE FASTENER INSTALLATIONS.



SERIES 1 L ATTACHMENTS ARE .250 THICK AND RATED AT 60 INCH POUNDS.

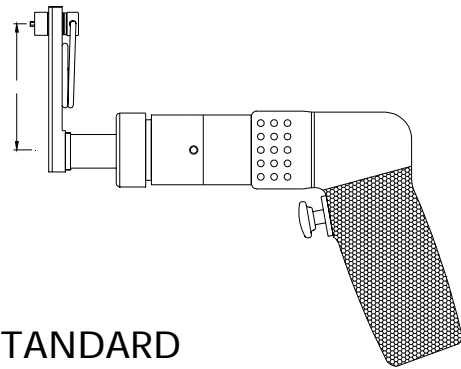
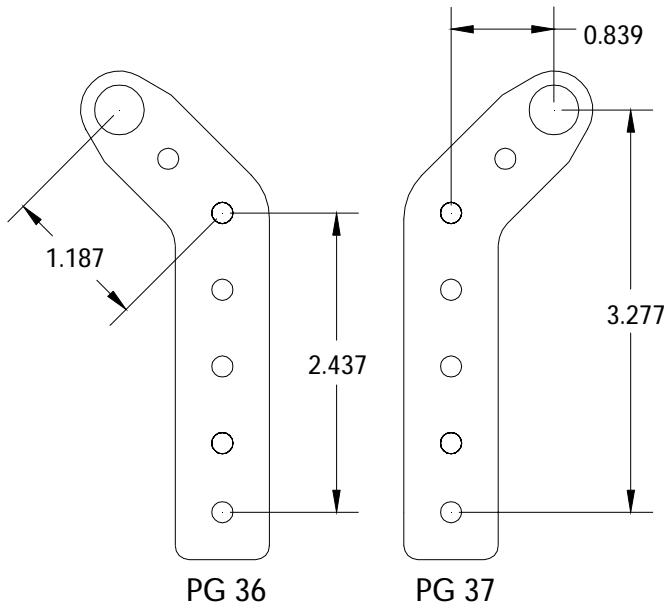

STANDARD OFFSETS

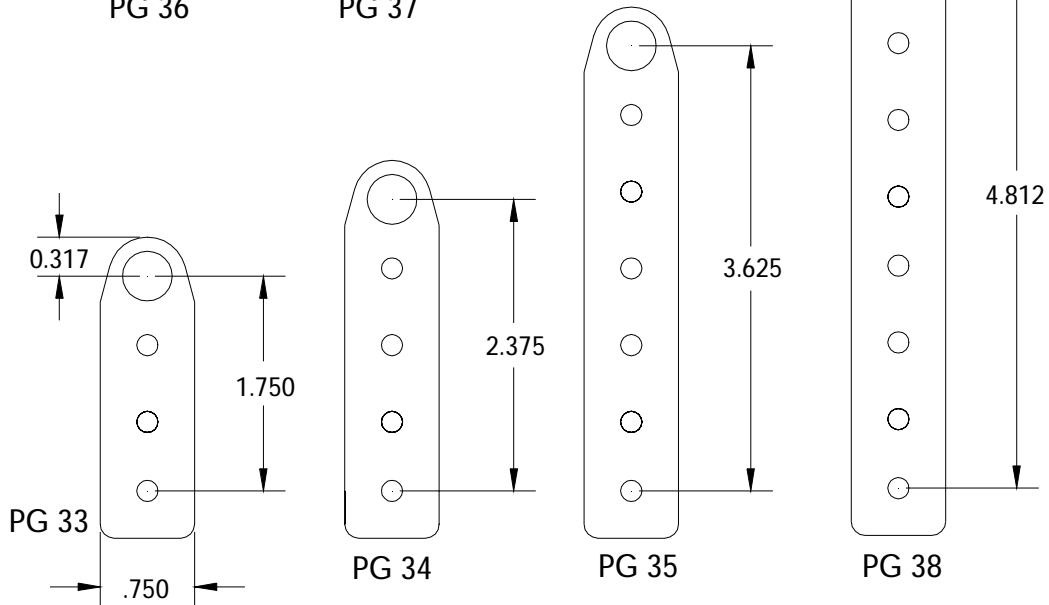

SERIES 1 ATTACHMENTS



OPTIONS

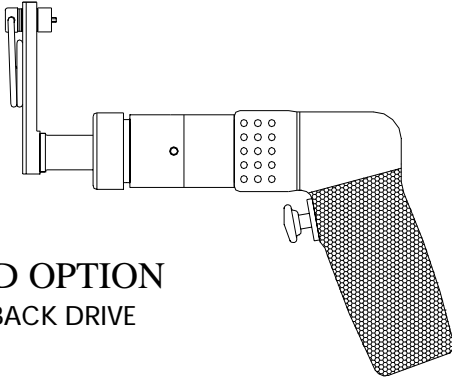

BD OPTION
BACK DRIVE

THE SOCKET, HEX KEY SET UP AND MOTOR ROTATION IS REVERSED FROM STANDARD

FOR BACK DRIVE
ADD BD AFTER TOOL ORDER NUMBER

X OPTION
12 POINT

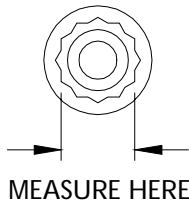

CHANGE TO 12 POINT CONFIGURATION

ADD X AFTER NOSE GEAR NUMBER

HD OPTION
HEAVY DUTY
LARGE NOSE

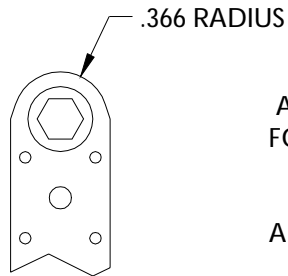

ALLOWS FOR A LARGER HEX SIZE FOR THE HEX THRU NOSE GEARS

ADD HD AFTER TOOL ORDER NUMBER

HD OPTION NOSE GEARS

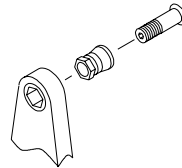

HEX THRU STYLE.
HEX RUNS THROUGH NOSE GEAR.
HEX KEY SPRING IS NOT SUPPLIED.

PART NO.	HEX SIZE	TYPE
15466	9/32	HEX THRU
15467	5/16	HEX THRU
15468	11/32	HEX THRU

HD OPTION NOT AVAILABLE FOR 13198, 13199, 13200, 13201
RIGHT AND LEFT HAND ATTACHMENTS