

	A	B	C	D	E	SERIES 2 20 DEG HW INSTALLATION	
INCH	.500	1.400	.500	2.275	1.250	MAXIMUM RECOMMENDED FASTENER TORQUE	160 INCH LBS.
MM	12.7	35.5	12.7	57.7	31.7		18.07 Nm

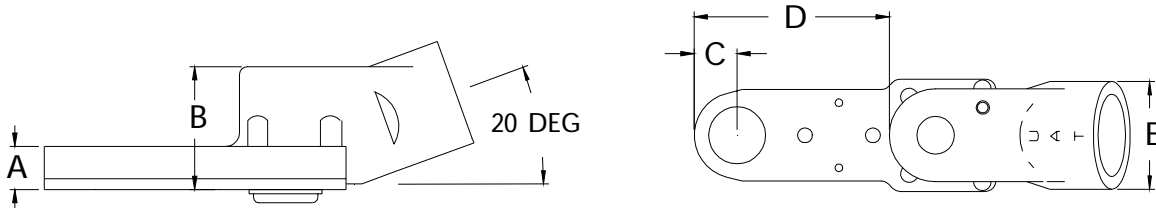

**STALL TYPE
16077 ATTACHMENT ONLY
20 DEGREE SERIES 2 HW INSTALLATION**



-10 PIN MAX

* Maximum torque of the motor exceeds the maximum torque range of the attachment. High maintenance should be expected when operated at the upper torque capacity range.

STALL TYPE 20 DEGREE TOOLS					OUTPUT AT FASTENER		TOOL ORDER NUMBER
MOTOR	RPM	RPM FASTENER	REVERSIBLE	TYPE	TORQUE INCH LB.	TORQUE Nm	
.40	250	100	YES	SRD1	160*	18.0*	16085
.40	450	180	YES	SRD1	160*	18.0*	16086
.40	1000	400	YES	SRD1	140	15.8	16087
.60	250	100	NO	SD2	160*	18.0*	16088
.60	450	180	NO	SD2	160*	18.0*	16089
.60	1000	400	NO	SD2	160*	18.0*	16090

TOOL LENGTH			
RPM	TYPE	INCH	MM
250	SRD1	12.1	307
450	SRD1	11.2	284
1000	SRD1	11.2	284
250	SD2	12.1	307
450	SD2	11.2	284
1000	SD2	11.2	284

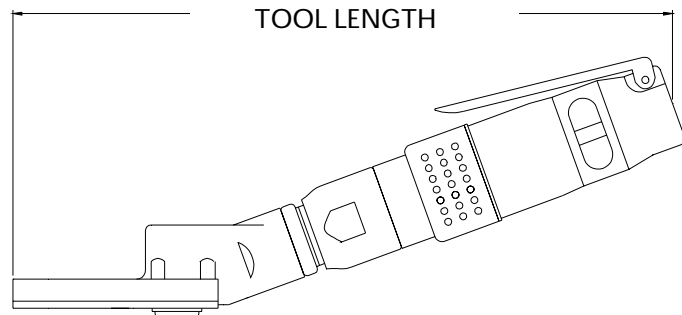

NOSE GEARS FOR SOCKETS.
5/16 HEX DRIVER FOR HD SERIES 2 SOCKETS.
5/16 HEX DRIVER FOR EDDIE BOLT SOCKETS.

PART NO.	HEX SIZE	TYPE
15922	5/16	HEX DRIVER
15905	1/4	SQ. DRIVE MALE

FLUSH STYLE.
THE SOCKET HEX IS BUILT INTO THE GEAR OF THE TOOL.
NO SOCKET IS USED

PART NO.	HEX SIZE	TYPE
15889	11/32	HEX FLUSH
15890	3/8	HEX FLUSH
15891	7/16	HEX FLUSH
16038	5/16	HEX FLUSH

HEX THRU STYLE.
HEX RUNS THROUGH NOSE GEAR.
HEX KEY SPRING IS NOT SUPPLIED.

PART NO.	HEX SIZE	TYPE
15892	11/32	HEX THRU
15893	3/8	HEX THRU
15894	7/16	HEX THRU
16039	5/16	HEX THRU

*"EDDIE BOLT" IS A TRADEMARK OF FAIRCHILD CORPORATION