

	A	B	C	D	E	F	G	SERIES 2 L DRILL	
INCH	.327	4.484	.900	.350	5.252	4.552	1.858	MAXIMUM RECOMMENDED DRILL DIAMETER	.250 INCH
MM	8.30	113.8	22.86	8.89	133.4	115.6	47.19		6.35 mm

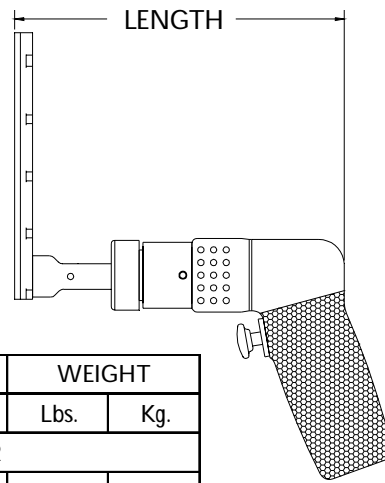

13827 ATTACHMENT ONLY SHORT

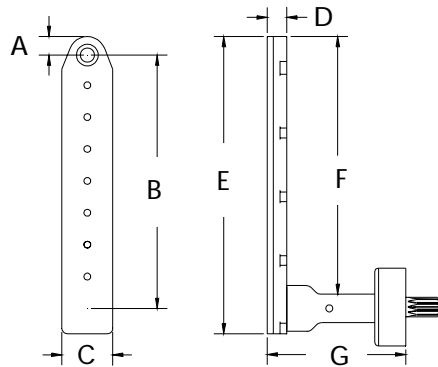

TOOL ORDER NUMBER	R.P.M.	LENGTH		WEIGHT	
		Inch	mm	Lbs.	Kg.
D SERIES .30 HP MOTOR					
16371	250	7.00	177.8	1.80	0.81
14573	500	7.00	177.8	1.80	0.81
14574	750	7.00	177.8	1.80	0.81
14575	1000	7.00	177.8	1.80	0.81
14576	1500	7.00	177.8	1.80	0.81
14577	2800	6.10	154.9	1.52	0.68
D2 SERIES .60 HP MOTOR					
16372	250	8.95	227.3	3.37	1.53
14578	450	8.35	212.0	2.67	1.21
14579	1000	8.35	212.0	2.67	1.21
14580	2000	7.10	180.3	2.42	1.09
14581	2700	7.10	180.3	2.42	1.09
14582	3500	7.10	180.3	2.42	1.09
RD2 .40 HP REVERSIBLE MOTOR					
16373	250	8.95	227.3	3.37	1.53
14583	450	8.35	212.0	2.92	1.32
14584	1000	8.35	212.0	2.92	1.32
14585	2000	7.10	180.3	2.67	1.21
14586	2700	7.10	180.3	2.67	1.21
14587	3500	7.10	180.3	2.67	1.21

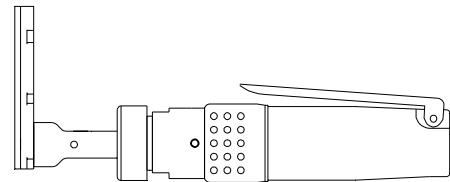

Add an S after the tool order number for the straight handle option.

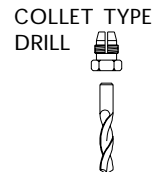

INTERNAL THREAD	
ADD TO TOOL No.	
1/4-28	A
10-32	C
9/32-40	E
5/16-24	F
COLLET	D